

BL Series 100mm CHART DOT-PRINTING TYPE HYBRID RECORDER



MODEL BL□6□

The BL Series hybrid chart recorders are easy to operate and use the reliable dot-printing method to record a variety of information in analog and digital formats on a 100mm wide chart. Not only can each measured value be read from the custom made analog scale plate but a comprehensive LED display also enables precise digital measurements to be taken by the user. The compact BL Series instruments have depth of only 195mm which makes them suitable for space sensitive installations including panel mounting.



■ FEATURES

- **Ready to run immediately**
As the recorders are pre-set to meet individual customer specifications and precise application requirements, the units start indicating and recording as soon as they are switched on.
- **Dual displays for accuracy and simplicity**
Measured values can be read at a glance, directly from the triple scale analog display plate whilst a digital display clearly indicates measured values, alarm settings and chart speed together with a range of other information.
- **Compact and easy to install**
The BL recorders are designed for use in applications where space is at a premium. With a reduced depth of 195mm and weighing 2.6kg, the instruments are ideally suited for panel mounted installations.
- **Abundant functions installed**
An abundance of easy -to-use functions including skip function, digital recording, year/month! day printing and key lock are installed. A variety of options including high-speed-dotting, external drive, alarm output and 16m length chart paper are prepared to meet every requirements.
- **Input signal shift function**
Shift correction of indications can be done every point according to the sensor input signals. The indication and recording scale positions can be corrected.

■ MODELS

B □ 6 □ □ □ □ □



Input signals

- 1: Thermocouple, DC voltage, Single range
- 2: Resistance thermometer, Single range
- 5 : Thermocouple, DC voltage, Individual ranges by channel*
- 6 : Resistance thermometer, DC voltage (5V), Individual ranges by channel*

Individual alarm outputs (option)

- 0: Not provided.
- 6: 6 points

CE-marking (option)

- : Not provided
- E : with CE-marking

Communication interface (option)

- N: Not provided
- A: RS-422A
- R: RS-232C
- S: RS-485

External drive(option)

- N: Not provided
- D: Provided

- For the combinations by channels, refer to the reference measuring range.

■ NAMES AND FUNCTIONS OF COMPONENT PARTS

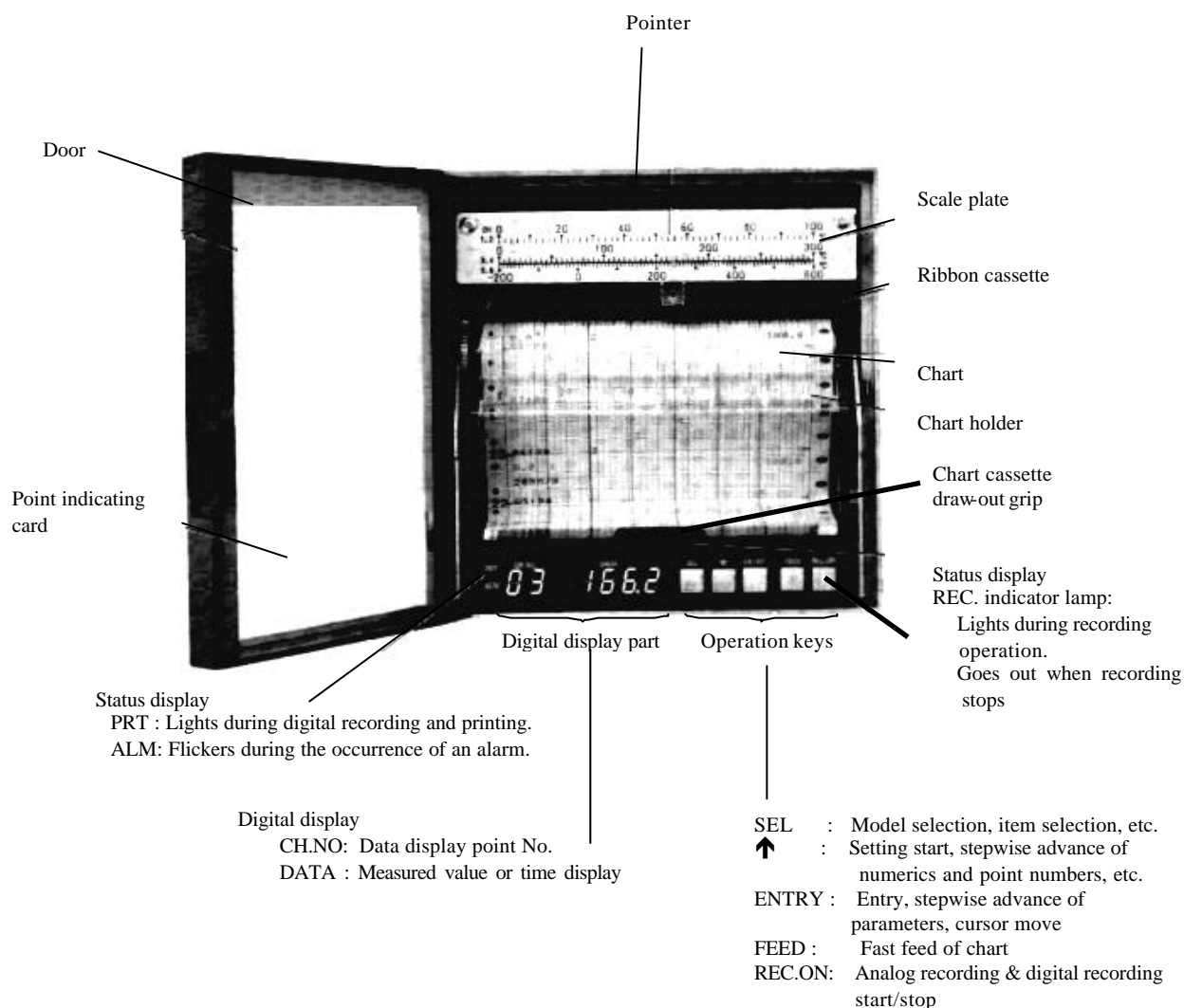

■ RECORDING FORMAT

· Fixed time digital printing

Time, scale, chart speed, setting change mark, and hour lines are printed on analog recording at optional time intervals together with data recording.

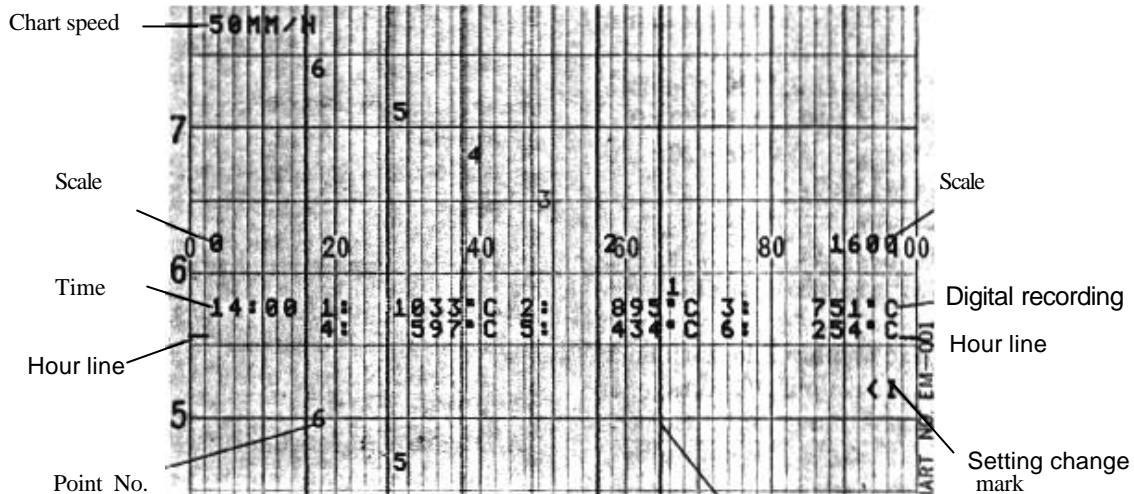

· Instantaneous digital recording

When the latest data are necessary, analog recording is interrupted at once to record these data.

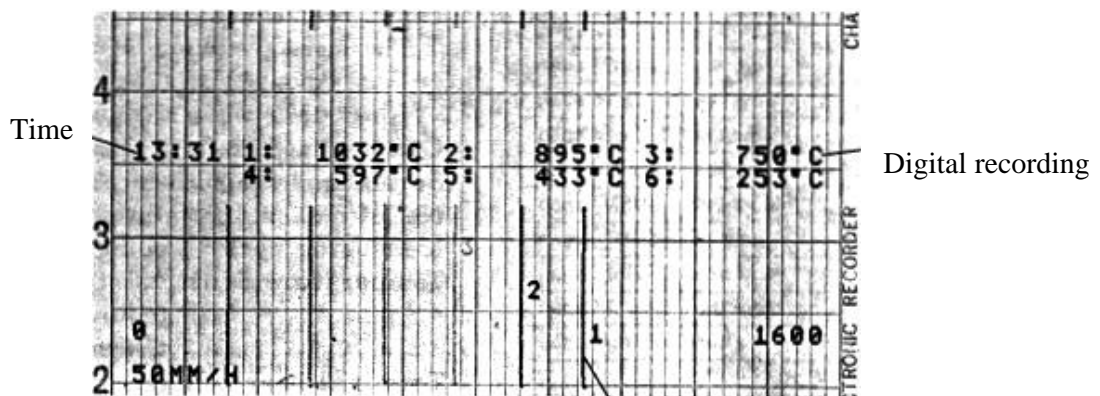

Analog recording

· Printing of occurrence and reset of alarms

Time, point No., alarm type, and level are printed when an alarm occurred and the alarm was reset.

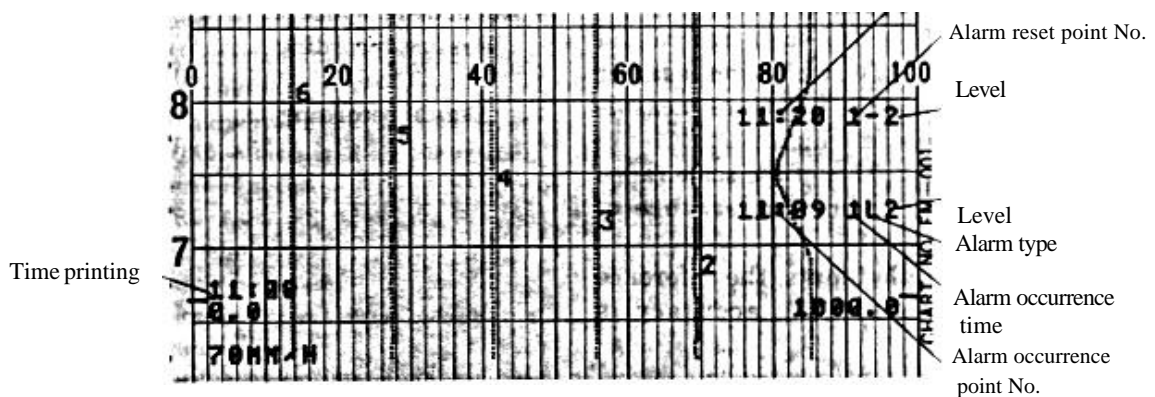

■ GENERAL SPECIFICATIONS

Input signals:

DC voltage $\pm 7\text{mV}$, $\pm 14\text{mV}$, $\pm 25\text{mV}$,
 $\pm 70\text{mV}$, $\pm 5\text{V}$

DC current Applicable by adding a shunt
resistor (100Ω , 250Ω)

Thermocouple.....B, H, S, K, E, J, T, N, Ni-NiMo,
AuFe-Cr, PR5-20, PR20-40,
WWR5-26, WWR5-26,
Platinel, U, L

Resistance thermometer

.....Pt100, JPt100, Pt-Co

Specify from the standard scale table every
input point.

(These input signals are combinable with each
other in case of the thermocouple/DC voltage, or
resistance thermometer/5V range only. See the
reference setting range.)

Max. triple scale plate is available.

Scale : Specify the scales within the minimum
setting range.

Reference measuring range	Minimum measuring range
7.0mV range	More than 3.2mV span
14.0mV range	More than 6.3mV span
25.0mV range	More than 11.3mV span
70.0mV range	More than 31.5mV span
5.0V range	More than 2.3V span
120 Ω range	More than 20.0 Ω span
140 Ω range	More than 20.0 Ω span
160 Ω range	More than 27.0 Ω span
220 Ω range	More than 54.0 Ω span
340 Ω range	More than 108.0 Ω span

*The reference voltage input is 0mV (0V), while the
reference resistance input is 100 Ω

*See the reference setting range.

Accuracy rating: Digital indications and printing

Thermocouple, resistance thermometer

..... $\pm 0.3\%$ of the scale range ± 1
digit or $\pm 1^\circ\text{C}$, whichever is larger

DC voltage $\pm 0.2\%$ of the reference measuring
range ± 1 digit

Analog indication $\pm 0.5\%$ of the scale range

*Note: Accuracy at a room temperature of
 $23^\circ\text{C} \pm 2^\circ\text{C}$

*Note: For thermocouple inputs, the reference junction
compensating accuracy is excluded.

*Exceptional setting of accuracy rating

Input type	Scale	Accuracy rating (with reference to the reference measuring range)
WWR5-26	0 to 100°C	$\pm 0.3\% \pm 1$ digit
PR20-40	0 to 300°C 300 to 800°C	$\pm 1.5\% \pm 1$ digit $\pm 0.8\% \pm 1$ digit
PR5-20	0 to 100°C 100 to 200°C	$\pm 4\%$ $\pm 0.5\% \pm 1$ digit
AuFe-Cr	0 to 20K 20 to 50K	$\pm 0.5\% \pm 1$ digit $\pm 0.3\% \pm 1$ digit
Pt-Co	4 to 20K 20 to 50K	$\pm 0.5\% \pm 1$ digit $\pm 0.3\% \pm 1$ digit

Reference junction compensating accuracy:

K, E, J, T, N, Platinel ... Lower than $\pm 0.5^\circ\text{C}$

R,S,Ni-NiMo, AuFe-Cr, WWR5-26,

WWR5-26, U, L Lower than $\pm 1.0^\circ\text{C}$

A/D resolution: About 1/18000

Allowable signal source resistance:

Thermocouple input, DC voltage input

... Lower than 1k Ω (without burnout)

Resistance thermometer input

... Lower than 10 Ω per wire (Pt100, JPt100)

Input resistance:

Thermocouple input, DC voltage input

... About 8M Ω

*About 1M Ω when a voltage divider is used.

Common mode rejection ratio: More than 130dB

Series mode rejection ratio: More than 50dB

No. of measuring points: 6 points

Measuring cycle: 6 points about 5sec.

Temperature drift: $\pm 0.01\%$ of full scale/ $^\circ\text{C}$

(equivalent to E. M. F. for
thermocouple input)

Terminal board: Detachable type Removable for connections

Dot-printing cycle: About 5 sec/point (when the chart speed
is faster than 6mm/h)

Recording system:

Analog recording Wire dot system 6-color
ribbon

Digital recording Wire dot system 6-color
ribbon

Recording color:

Analog recording Red, black blue, green,
brown, purple

Digital recording

Fixed time digital recording.....

Repetition of 6 colors (red, black, blue, green,
brown, purple)

Instantaneous digital recording

Repetition of 6 colors (red, black, blue, green,
brown, purple)

Date (year, month, day) and time printing

Black

Scale, point No.

Same colors as dot printing colors

Chart speed Black

Alarm occurrence & reset printing

Red (option)

Setting change mark Black

Recording chart:

Fan-fold type 114mm total width, 10m total length,

100mm effective recording width

Chart speed:

10, 20, and 40mm/h (standard)

3-speed selection by DIP switches

*The speeds are optionally settable.

1 to 1500mm/h (1mm step)

Fixed time digital recording:

Time, point No., measured values, and units are
printed on analog recording at every specified
time interval.

Chart speed(mm/h)	Fixed time digital printing interval
0 to 5	Not printed.
6 to 15	24 hours
16 to 25	12 hours
26 to 35	8 hours
36 to 45	6 hours
46 to 65	4 hours
66 to 85	3 hours
86 to 155	2 hours
156 to 250	1 hour
251 or more	Not printed.

Instantaneous digital recording:

Time, point No., measured values, and units are
printed at the

request time by interrupting

analog recording.

Date and time printing:

Hour lines and time are printed on the hour
sharp. Date (year, month, and day) is printed
at zero hour sharp.

If this printing overlaps digital recording, time may
be not printed.

*The printing intervals depend upon the chart
speeds.

Chart speed(mm/h)	Time printing interval	Hour line printing interval
1	12 hours	6 hours
2	6 hours	3 hours
3	4 hours	2 hours
4	3 hours	2 hours
5 to 9	2 hours	1 hour
10 to 250	1 hour	1 hour
251 or more	Not printed.	Not printed.

Scale and point No. printing:

Point No. is printed at 6mm intervals beside
the analog recording. Scales are printed
sequentially every point at intervals of
48mm at 0% and 100% positions of the chart.

Chart speed printing:

The executing chart speed is printed on the 0 %
side of the chart at intervals of 84mm as well
as when the power supply is turned on.

*If digital printing is done halfway, the printing
interval is extended at a high chart speed.

Alarm occurrence and reset printing:

Time, point No., alarm type and level are
printed on the right side of the chart when
an alarm occurred.

Time, point No., and level are printed on the
right side of the chart when the alarm was reset.

Setting change mark printing:

A character indicating a change item is printed on the 100% side of the chart at the end of a setting change (when communication interface option is added).

Skip function:

None of analog indications, dot-printing, digital display, and printing is done at each point.

*If the chart speed is lower than 35mm/h, the dot-printing interval may be delayed.

Analog indications: Scale plate and scale pointer

Scale plate: Max. triple scale, 80 equal divisions

Status display:

Recording ON/OFF ...	Green LED, illumination switch
ALM	Red LED flickers when an alarm occurred.
PRT	Green LED lights during printing.

Digital display:

7-segment LED, character height 8mm
 2 digits ...Point No.
 5 digits ... Data display -9999 to 99999

Display items:

Multi-point sequential display, 1-point continuous display, and clock display are switched.

Setting mode display (setting, check, operation):

Digital display part is shared by key operation. Data printing (instantaneous digital recording) operation, chart speed setting, time setting, alarm setting (when the alarm option is added) data interval setting, skip setting

Continuous indication operation:

Input entry and continuous indications at specified points only (recording stop)

Kinds of keys:

REC. ON, FEED, ENTRY, ↑, SEL

Recording operation:

REC. ON ... Recording operation ON/OFF
 FEED Quick chart speed

Rated supply frequency:

50Hz/60Hz (selectable by DIP switches)

Maximum power consumption: Approx. 45VA

Working temperature range: 0 to 50°C

Working humidity range: 20 to 80%RH

Mounting position:

Forward tilting 0° Backward tilting 0 to 30°
 Lateral tilting 0°

Warm-up time: Longer than 30mm

Countermeasure against power interruption:

Setting data are kept unerased by EEPROM. Clock is backed up for longer than 10 years by a lithium battery (soldering)(assuming that the recorder is used for 8 hours a day).

Insulation resistance:

500VDC, higher than 20MΩ between measuring terminals and protective conductor terminal 500VDC, higher than 20MΩ between power terminals and protective conductor terminal 500VDC, higher than 20MΩ between measuring terminals and power terminals

Dielectric strength:

500VAC, 1mm between measuring terminals and protective conductor terminal
 1500VAC, 1mm between power terminals and protective conductor terminal
 1500VAC, 1mm between measuring terminals and power terminals

Casing:

Door ABS resin (heat-resisting temperature Max. 80°C)
 Rear casing ... ABS resin (heat-resisting temperature Max. 80°C)
 Power supply ... Steel plate

Color:

Door Black (equivalent to Munsell code N3.0)
 Rear casing Gray (equivalent to Munsell code N7.0)

Mounting method: Panel flush-mount

Weight: Approx. 3.0kg

• Transportation and storage conditions

Temperature: -20 to +60°C

Humidity : 5 to 95%RH (No condensing)

Vibrations : 10 to 60Hz 0.5G

Shock : Less than 40G

This is also offers the following maintenance functions. However these functions are performed by IBM-PC at CHINO's agents, world wide.

- **ENG1 mode** (Specifications check)
 - Input parameters (ranges, scales, units)
 - Alarm (mode, output destinations, AND/OR
 - * when an alarm option is provided.)
 - Recording colors
 - Key lock (Key lock condition check by means of communication)
- **ENG2 mode** (Communication option setting and external drive option output specifications)
 - Communication setting (addresses, baud rates, character configuration)
 - External drive information
- **Calibration**
 - Indications are calibrated on every channel.
 - Indications are shifted on every channel.
 - Chart scale position is corrected.
- **Memory clear**
 - Initialization of set values (Input types, ranges, scales, units, and chart speeds are reset to the set values at the delivery time from the works, and alarm is initialized to no setting)
 - Clock is initialized to Jan, 1, 1994.
 - Calibration data are initialized.
- **Hardware check**
 - Printer check, indicator check, DIP switch check, external drive check, version check, and alarm output contact check.

■ OPTION

Option name	Description
External drive	The following operation can be done by external contact signals. Operation type: 3-chart speed selection, recording stop, & data printing No. of contact points: 3 no-voltage contacts + 1 point (for a special request) Contact capacity: 12VDC, 2mA or higher *The depth is increased by 16mm when this option is added.
Communication interface	One of RS-232C, RS-422A, and RS-485 is to be specified. Communication contents: Transmission of measured values and status information. Setting and confirmation of parameters are settable by keys. *The depth is increased by 16mm when this option is added.

Option name	Description
Alarm output (6P)	No. of output points: 6 points Alarm type: Absolute value alarm, OR output * Differential alarm, change ratio alarm, standby alarm and AND output can be offered on request. Setting level: 2 levels/channel Contact capacity: 100VAC, 0.5A, resistive load 240VAC 50mA ("a" contact photo MOS relay) for CE-marking option *The depth is increased by 16mm when this option is added.
Extended alarm output	Alarm contact outputs of 12 points and 24 points together with alarm output (6P)
High-speed dot-printing	Dot-printing cycle. ~About 2.5sec/dot (when the chart speed is more than 12mm/h) *The dot printing cycle differs according to the chart speed when the chart speed is less than 2mm/h.
High voltage input	Voltage-dividing resistor is built in. Higher than 5VDC, but lower than 60VDC (channel fixed.)
Current input	A resistor is built in. Lower than 50mA (channel fixed, the resistor is externally mounted.)
Burnout	The pointer overshoots the high limit when input signals are interrupted. (except for voltage—dividing inputs, voltage/current inputs) Thermocouple input: Channels are fixed. Resistance thermometer input: All channels are fixed.
16m Chart	114mm total width 15.6m total length 100mm effective recording width
Math function	One of addition •subtraction•multiplication, square root, logarithm (common, natural), temperature humidity, integration is to be specified.
CE—marking	Standards EN5501 1 group 1 class A EN50082—2 (industrial environment) EN61010 — 1 + A2 •Rated supply voltage 100 to 240VAC • Case Steel plate (add 1 kg weight to standard model) • Reference junction compensation stability ±5°C under EMC test environment

■ REFERENCE MEASURING RANGES

Input type		Reference measuring range	Scale	Indicating resolution	Min. measuring range
DC voltage		± 7mV ± 14mV ± 25mV ± 70mV ± 5V	-7 to + 7mV -14 to +14mV -25 to +25mV -70 to +70mV -5 to +5V	1 μV 10 μV 10 μV 10 μV 1 mV	3.2 mV 6.3mV 11.3mV 31.5 mV 2.3V
Thermocouple	K	± 7mV ± 14mV ± 25mV ± 70mV	-150 to +150°C -200 to +300°C -200 to +600°C -200 to +1370°C	0.1°C 0.1°C 0.1°C 1°C	100°C 200°C 400°C 800°C
	E	± 25mV ± 70mV	-200 to +350 °C -200 to +900°C	0.1°C 1°C	200°C 500°C
	J	± 25mV ± 70mV	-200 to +450°C -200 to +1200°C	0.1°C 1°C	300°C 600°C
	T	± 7mV ± 14mV ± 25mV	-150 to +150°C -200 to +250°C -200 to +400°C	0.1°C 0.1°C 0.1°C	100°C 200°C 300°C
	R	± 25mV	0 to +1760°C	1°C	1200°C
	S	± 25mV	0 to +1760°C	1°C	1200°C
	B	± 14mV	400 to +1820°C	1°C	1200°C
	N	± 7mV ± 14mV ± 25mV ± 70mV	0 to +200°C 0 to +350°C 0 to +700°C 0 to +1300°C	0.1°C 0.1°C 0.1°C 1°C	150°C 300°C 400°C 900°C
	WVR5-26	± 70mV	0 to +2320°C	1°C	1900°C
	WVR5-0-26	± 70mV	0 to +2320°C	1°C	1900°C
	PR20-40	± 7mV	0 to +1880°C	1°C	1500°C
	PR5-20	± 14mV	0 to +1800°C	1°C	1200°C
	Ni-NiMo	± 70 mV	0 to +1310°C	1°C	700°C
	AuFe-Cr	± 7mV	0 to 300k	0.1k	180k
	Platinel	± 7mV ± 14mV ± 25mV ± 70mV	-100 to +150°C -100 to +1390°C	0.1°C 0.1°C 0.1°C 1°C	100°C 200°C 400°C 800°C
	U	± 7mV ± 14mV ± 25mV ± 70mV	-150 to +150°C -200 to +250°C -200 to +450°C -200 to +600°C	0.1°C 0.1°C 0.1°C 1°C	100°C 200°C 300°C 600°C
Resistance Thermometer	L	± 25mV ± 10mV	-200 to +450°C -200 to +900°C	0.1°C	300°C 600°C
	Pt 100	120 Ω 140 Ω 160 Ω 220 Ω 340 Ω	-50 to +50 °C -100 to +100°C -140 to +150°C -200 to +300°C -200 to +649°C	0.1°C 0.1°C 0.1°C 1 °C 0.1°C	50°C 100°C 150°C 200°C 400°C
	JPt100	120 Ω 140 Ω 160 Ω 220 Ω 340 Ω	-50 to +50°C -100 to +100 °C -140 to +150 °C -200 to +300 °C -200 to +649 °C	0.1°C 0.1°C 0.1°C 1°C 0.1°C	50°C 100°C 150°C 200°C 400°C
	Old Pt50	220Ω	-200 to +649°C	0.1°C	300°C
	Pt-Co	220Ω	4 to 374k	0.1k	200k

■ STANDARD SCALES

Input type		Working	Standard scale
DC voltage/		± 7mV ± 14mV ± 25mV ± 10mV ± 5V	-5 to +5mV, 0 to 5mV -10 to +10mV, 0 to 10mV 0 to 20mV 0 to 50mV 1 to 5V, 4 to 20mA, 10 to 50mA (The scale plate is equally divided into 0 to 100 divisions)
Thermocouple	K	± 7mV ± 14mV ± 25mV ± 70mV	0 to 100°C, 0 to 150°C, -50 to +150°C -50 to +150°C, -100 to +50°C 0 to 200°C, 0 to 250°C, 0 to 300°C 50 to +200°C, -100 to +200°C 0 to 400°C, 0 to 500°C, 0 to 600°C 0 to 800°C, 0 to 1000°C, 0 to 1200°C
	E	± 25mV ± 70mV	0 to 200°C, 0 to 300°C, -50 to +150°C 0 to 500°C, 0 to 600°C, 0 to +800°C
	J	± 25mV ± 10mV	0 to 300°C, 0 to 400°C 0 to 600°C, 0 to 800°C, 0 to 1000°C, 0 to 1200°C
	T	± 7mV ± 14mV ± 25mV	0 to 150°C, 0 to 200°C -50 to +150°C 0 to 200°C, 0 to 250°C 0 to 300°C, 0 to 400°C
	R	± 25mV	0 to 1200°C, 0 to 1400°C 0 to 1600°C
	S	± 25mV	0 to 1400°C, 0 to 1600°C
	B	± 14mV	0 to 1200°C, 0 to 1400°C 0 to 1600°C
	N	± 7mV ± 14mV ± 25mV ± 70mV	0 to 150°C, 0 to 200°C 0 to 300°C 0 to 400°C, 0 to 500°C, 0 to 600°C 0 to 1000°C, 0 to 1200°C
	PR20-40	± 7mV	0 to 1600°C
	PR5-20	± 70 mV	0 to 800°C, 0 to 1000°C ~ to 1200°C 0 to 1600°C
	Ni-NiMo	± 70 mV	0 to 800°C, 0 to 1000°C ~ to 1200°C 0 to 1600°C
	Platinel	± 1mV ± 14mV ± 25mV ± 10mV	0 to 100°C, 0 to 150°C 0 to 200°C, 0 to 250°C, 0 to 300°C 0 to 400°C, 0 to 500°C, 0 to 600°C 0 to 800°C, 0 to 1000°C, 0 to 1200°C
	U	± 1mV ± 14mV ± 25mV ± 10mV	0 to 100°C, 0 to 150°C 0 to 200°C, 0 to 250°C 0 to 300°C, 0 to 400°C 0 to 600°C
	L	± 25mV ± 10mV	0 to 300°C, 0 to 400°C 0 to 600°C, 0 to 800°C
Resistance Thermometer	Pt 100	120 Ω 140 Ω 160 Ω 220 Ω 340 Ω	-50 to +50°C, 0 to 50°C 0 to +100°C, -20 to +80°C 0 to 150°C, 50 to +150°C 0 to 200°C, 0 to 300°C 0 to 400°C, 0 to 500°C, 0 to 600°C
	JPt100	120 Ω 140 Ω 160 Ω 220 Ω 340 Ω	-50 to +50°C, 0 to 50°C 0 to 100°C, -20 to +80°C 0 to 150°C, -50 to +150°C 0 to 200°C, 0 to 300°C 0 to 400°C, 0 to 500°C, 0 to 600°C

* Caution) The minimum measuring ranges of the temperature scale are reference values. (They vary more or less according to the temperature ranges.)

* Select the combinations of input scales out of the following four kinds in case of the scales by points.

1. Thermocouple, DC voltage type 1 : 7mV, 14mV, 25mV, 5V
2. Thermocouple, DC voltage type 2 : 14mV, 25mV, 70mV, 5V
3. Resistance thermometer, 5V type 1 : 120 Ω, 140 Ω, 160 Ω, 5V
4. Resistance thermometer, 5V type 2 : 160 Ω, 220 Ω, 340 Ω, 5V

■ ACCESSORIES

Name of accessories	Q'ty	Remarks
Recording chart	1 pad	Fan—fold type, 20m in total length
Mounting bracket	2 pcs.	Used for panel mounting.
Channel indicating card	1 sheet	Attached to the door for describing the measuring titles of individual channels (The functions of DIP switches are described on the rear panel.)
Ribbon cassette	1 pc.	6-color ink ribbon for analogue and digital recording
Auxiliary terminal screw	5 pcs.	Use these input (alarm) terminal screws if they are missing (3.5mm in thread diameter).
Lubricating oil	1 bottle	Contains 10cc.
Instruction manual	1 pad	
Inspection certificate	1 sheet	Delivery inspection certificate

■ CONSUMABLES

Article names	Sales unit
Recording chart	15 pads/case
6-color ink ribbon cassette	1 pc/case
Lubricating oil	1 bottle
Mounting bracket	2 pcs. (for one unit)

■ TERMINAL BOARD

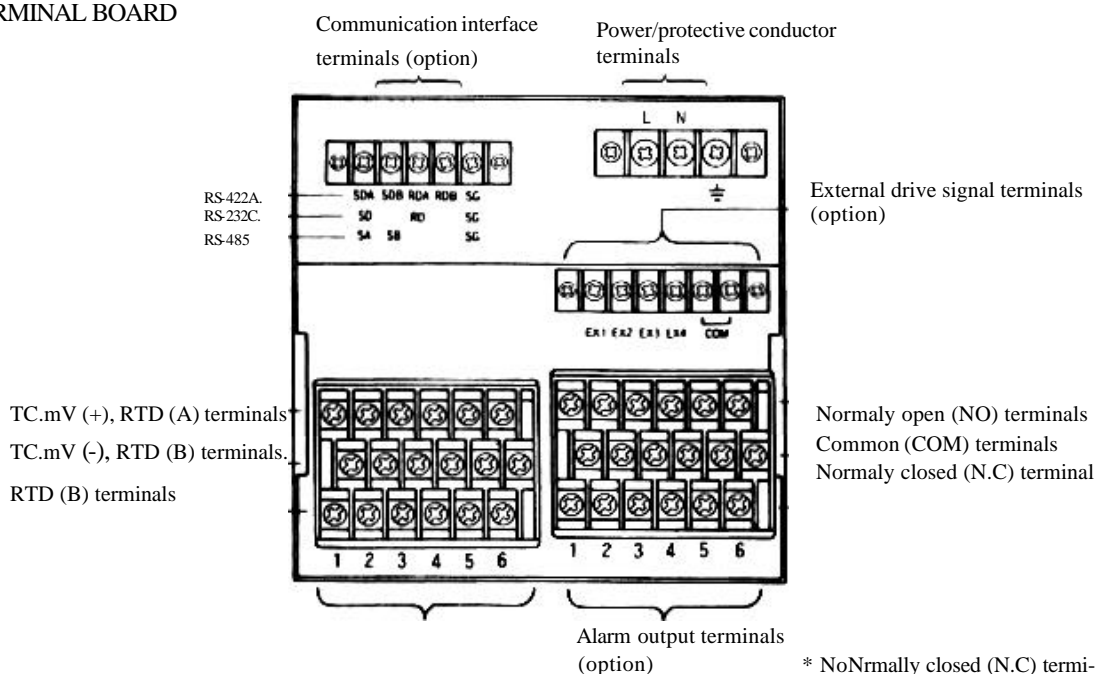

■ EXTERNAL DIMENSIONS

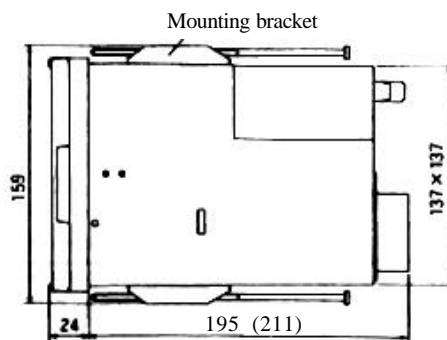
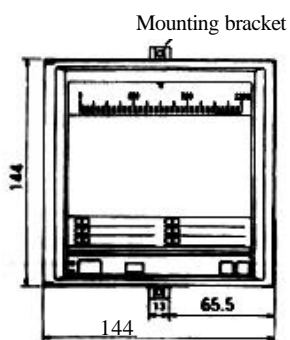

*(When external drive, alarm output or communication interface function is added.)

• Panel Cutout/Minimum instrument mounting space

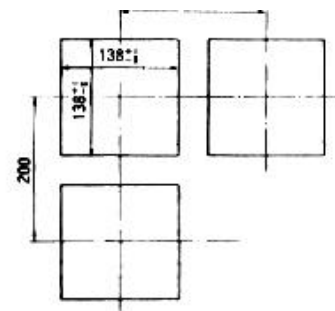

HOW TO ORDER

1. Model : BL _ 6 _ _ D _
2. Power source : 100VAC line or 200VAC line
(To be specified)
- *No need to specify the above for CE-marking
(100 to 240VAC free power source)
3. Chart speed : Standard 10, 20, 40mm/h Specified
____ , ____ , _____ mm/h

4. Input type and scale:

Point No.	Input type	Scale range (incl.deci.point)	Printing unit
1.		to	
2.		to	
3.		to	
4.		to	
5.		to	
6.		to	

Example

Point No.	Input type	Scale	range	Printing unit
1-3	K	0.0 to	400.0	°C

Printing unit is 2 digits. (°C shows 2 digits.) Shunt resistor

Shunt resistor for current input

Built-in or external

5. Scale Plate:

	Scale range	Unit
1.	to	
2.	to	
3.	to	

* Maximum 3 multi scale

Unit: Max. 10 characters (Single scale)

Max. 6 characters (Multi scale)

6. Alarm option:

Alarm designation: Standard _ , Exclusive _

* In case exclusive is specified, write exclusive specifications in the right table.

* Parenthesized () settings show the standard settings.

* Enter alarm set values by keys.

* Alarm output is up to 2 levels per channel.

* Alarm type: H; High limit absolute value alarm,
L; Low limit absolute value alarm, B; Differential
high limit alarm, S; Differential low limit alarm,
U; Change ratio increase limit alarm, D; Change
ratio decrease limit alarm.

These alarms are settable. Fill the option parameters with a
with a reference channel when the differential alarm is selected,
or fill the option parameter with scanning cycle (1 to 9) when
the change ratio alarm is selected.

Add W to the alarm type, if a standby alarm is necessary.

(Example: WH,WL)

* An alarm output AND connection is possible.

Write in the option parameters.

OR output : Alarm output is executed when one of
alarm points becomes alarm condition.

AND output : Alarm output is executed when all
alarm points becomes alarm condition.

* Alarm output numbers are freely settable in the range
of 1 to 6.

Example: 12-point alarm outputs are possible on 6-point
instrument.

Points	Level	Alarm type	Output No.	Output	Alarm set value	Parameters
1	1	(H)	(1)	(OR)		
	2	(L)	(1)	(OR)		
2	1	(H)	(2)	(OR)		
	2	(L)	(2)	(OR)		
3	1	(H)	(3)	(OR)		
	2	(L)	(3)	(OR)		
4	1	(H)	(4)	(OR)		
	2	(L)	(4)	(OR)		
5	1	(H)	(5)	(OR)		
	2	(L)	(5)	(OR)		
6	1	(H)	(6)	(OR)		
	2	(L)	(6)	(OR)		

Specifications subject to change without notice. Original 2001.6

CHINO CORPORATION

32-8, KUMANO-CHO, ITABASHI-KU, TOKYO 173-8632

PHONE: +81-3-3956-2171

FAX: +81-3-3956-0915

E-mail: inter@chino.co.jp

Website: http://www.chino.co.jp